



He Mahire Mōhiotanga Whenua Land Information Memorandum Maps

Civic Centre, 1061 Haupapa Street, Private Bag 3029, Rotorua Mail Centre, Rotorua 3046
P 07 348 4199 | F 07 346 3143 | E info@rotorualc.nz | W rotorualakescouncil.nz

Locality Map

Address:	149A Sunset Road Mangakakahi Rotorua 3015	Valuation:	06555 139 00 B
-----------------	---	-------------------	----------------

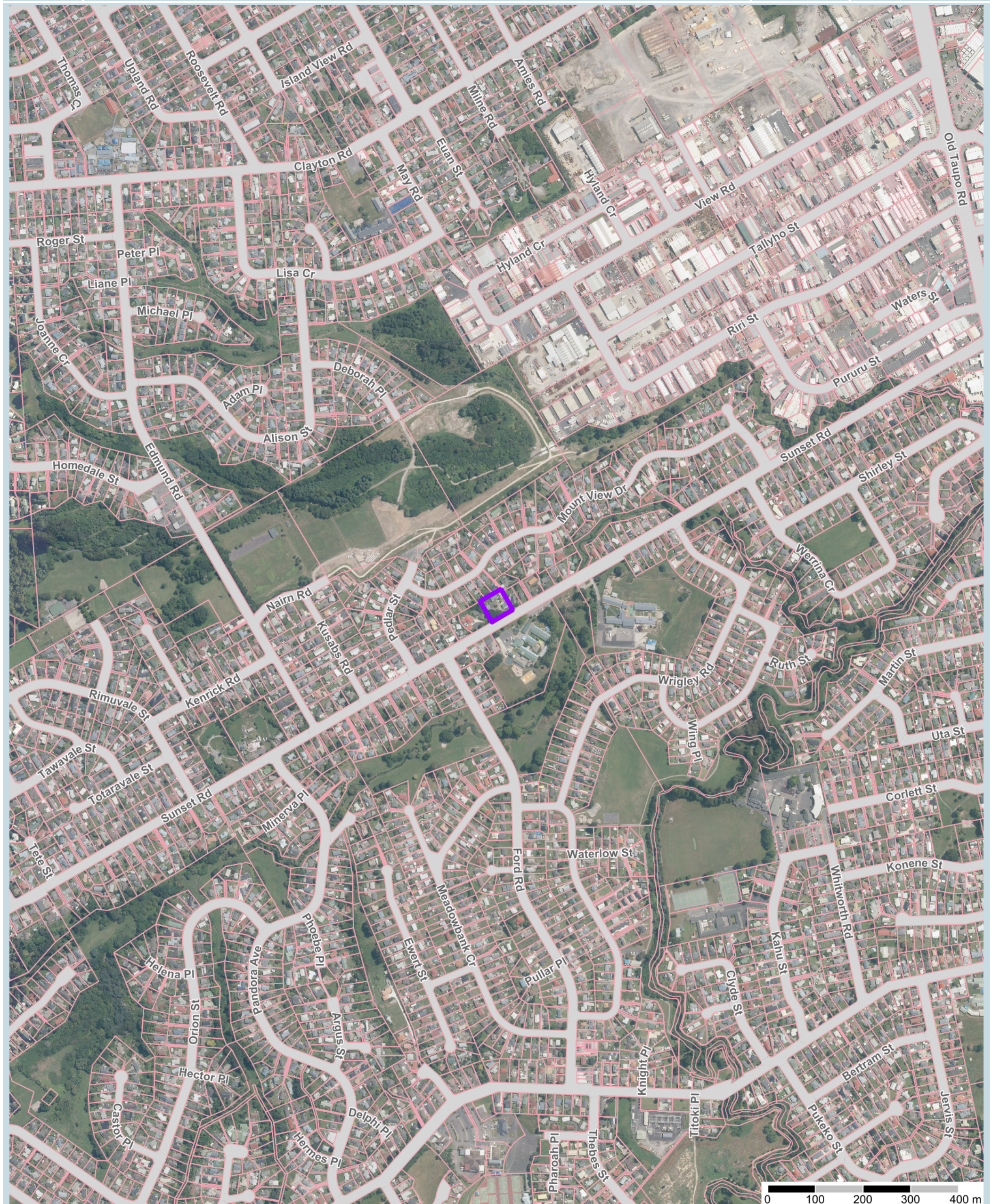

DATA SETS: Accuracy of property boundaries +/- 0.2m – 0.3m in urban areas and up to +/- 50m in rural areas. Property boundaries, titles, legal descriptions and legal areas sourced from LINZ. LINZ licenses. CROWN COPYRIGHT RESERVED. Council does not warrant the accuracy of the information represented by this map.



Aerial Photography

An aerial photograph of a residential neighborhood with property boundaries outlined in red. A specific parcel is highlighted with a thick purple border. The highlighted parcel is located between Sunset Rd to the south and Mount View Dr to the north. It contains several buildings, including a large green-roofed structure labeled 143, a smaller building labeled 147, and a large house labeled 149B. Other nearby parcels are labeled with numbers such as 72A, 72B, 72C, 74, 74B, 131A, 131B, 131C, 135, 137, 139, 141, 151, 152, 153, 154, 155, 156, 158, 159A, 159B, 159C, 161, 60, 60A, 66, 68, 70, 72A, 72B, 72C, 74, 76, 78, 80, 82, 91, 93, 95, 97A, 99, 101, 105, 130, 145, 149A, 149B, 151, 152, 153, 154, 155, 156, 158, 159A, 159B, 159C, 161, 60, 60A, 66, 68, 70, 72A, 72B, 72C, 74, 76, 78, 80, 82, 91, 93, 95, 97A, 99, 101, 105, 130, 145, 149A, 149B, 151, 152, 153, 154, 155, 156, 158, 159A, 159B, 159C, 161. The map also shows Mount View Dr, Sunset Rd, and a scale bar at the bottom right indicating distances from 0 to 40 meters.

Civic Centre, 1061 Haupapa Street, Private Bag 3029, Rotorua Mail Centre, Rotorua 3046
P 07 348 4199 | F 07 346 3143 | E info@rotorualc.nz | W rotorualakescouncil.nz

Water Supply

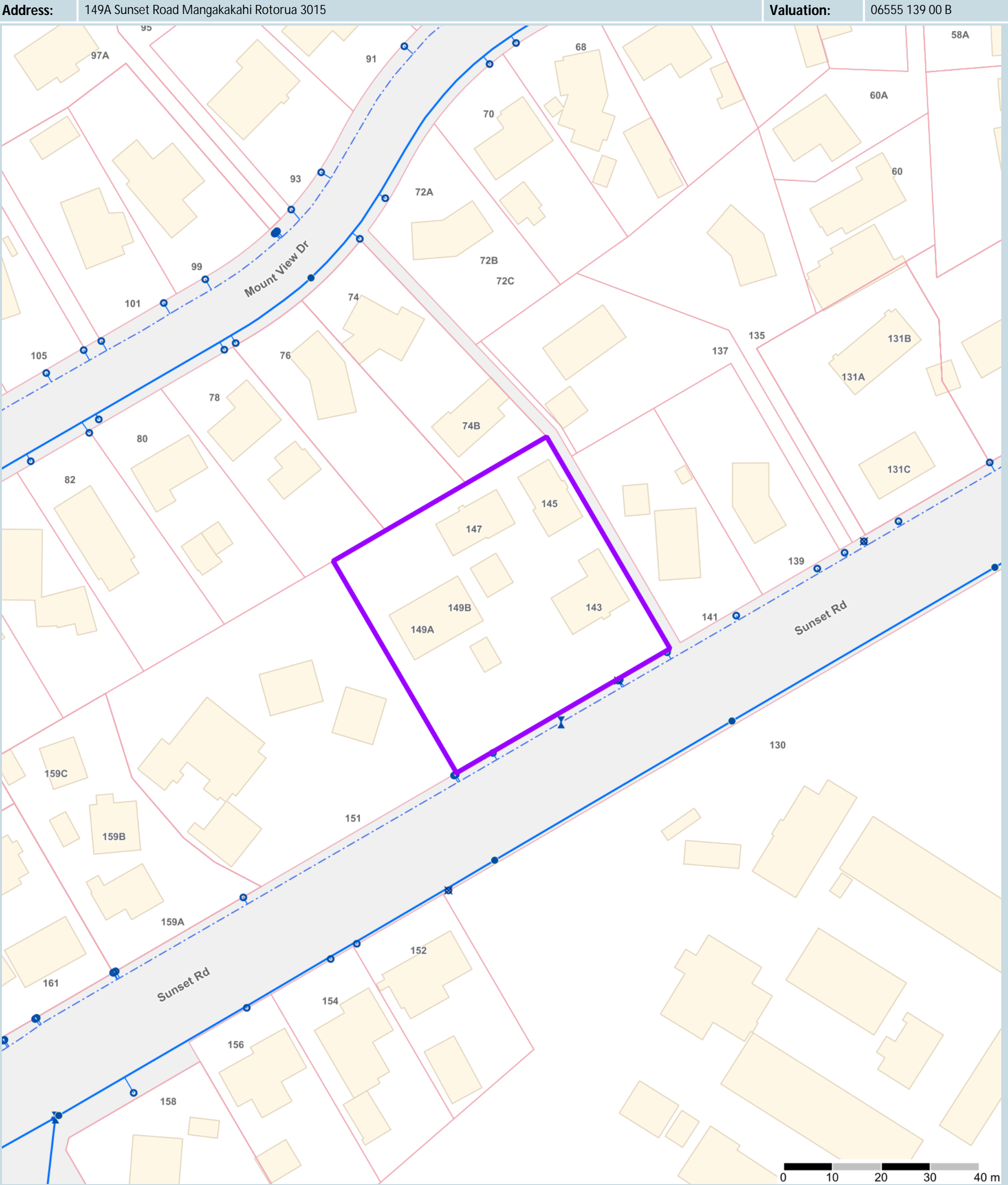

Backflow Preventer	Hydrant	Valve	Delivery, Trunk or Transfer Main	Scour or Overflow Main	Parcel
Consumer Meter at Toby	Capped End	Service Line	Rising or Rising Falling Main	NonPotable Fire Main	Structure Roofline
Bulk Meter	Chamber	Rider Main	Contour (1m)		

DATA SETS: Accuracy of property boundaries +/- 0.2m – 0.3m in urban areas and up to +/- 50m in rural areas. Property boundaries, titles, legal descriptions and legal areas sourced from LINZ. Structure Rooflines sourced from 2016 and updated from 2024 imagery.
LINZ licenses. CROWN COPYRIGHT RESERVED. Council does not warrant the accuracy of the information represented by this map.



Civic Centre, 1061 Haupapa Street, Private Bag 3029, Rotorua Mail Centre, Rotorua 3046
P 07 348 4199 | F 07 346 3143 | E info@rotorualc.nz | W rotorualakescouncil.nz

Storm Water

Address:149A Sunset Road Mangakakahi Rotorua 3015

Valuation:06555 139 00 B

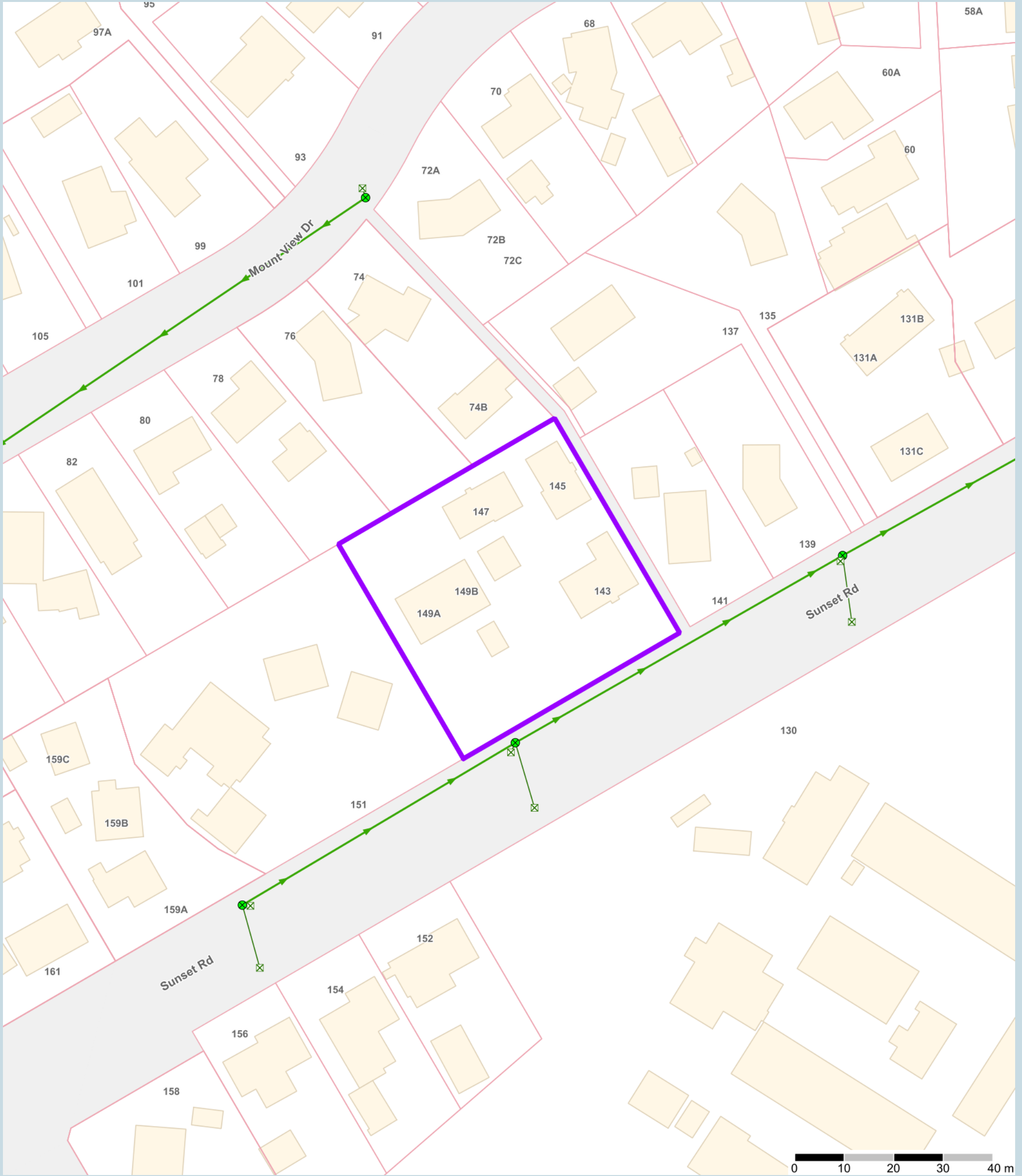

Manhole

Capped End of Line

Headwall Structure

Junction without Manhole

Cesspit Bubble Up

Cesspit Double

Cesspit Standard

Open Drain

Lead

Service Line

Culvert

Gravity Main

Rising main

Subsoil Drain

Contour (1m)

Parcel

Structure Roofline

DATA SETS: Accuracy of property boundaries +/- 0.2m – 0.3m in urban areas and up to +/- 50m in rural areas. Property boundaries, titles, legal descriptions and legal areas sourced from LINZ. Structure Rooflines sourced from 2016 and updated from 2024 imagery.
LINZ licenses. CROWN COPYRIGHT RESERVED. Council does not warrant the accuracy of the information represented by this map.



Civic Centre, 1061 Haupapa Street, Private Bag 3029, Rotorua Mail Centre, Rotorua 3046
P 07 348 4199 | F 07 346 3143 | E info@rotorualc.nz | W rotorualakescouncil.nz

Waste Water

Address:	149A Sunset Road Mangakakahi Rotorua 3015	Valuation:	06555 139 00 B
----------	---	------------	----------------

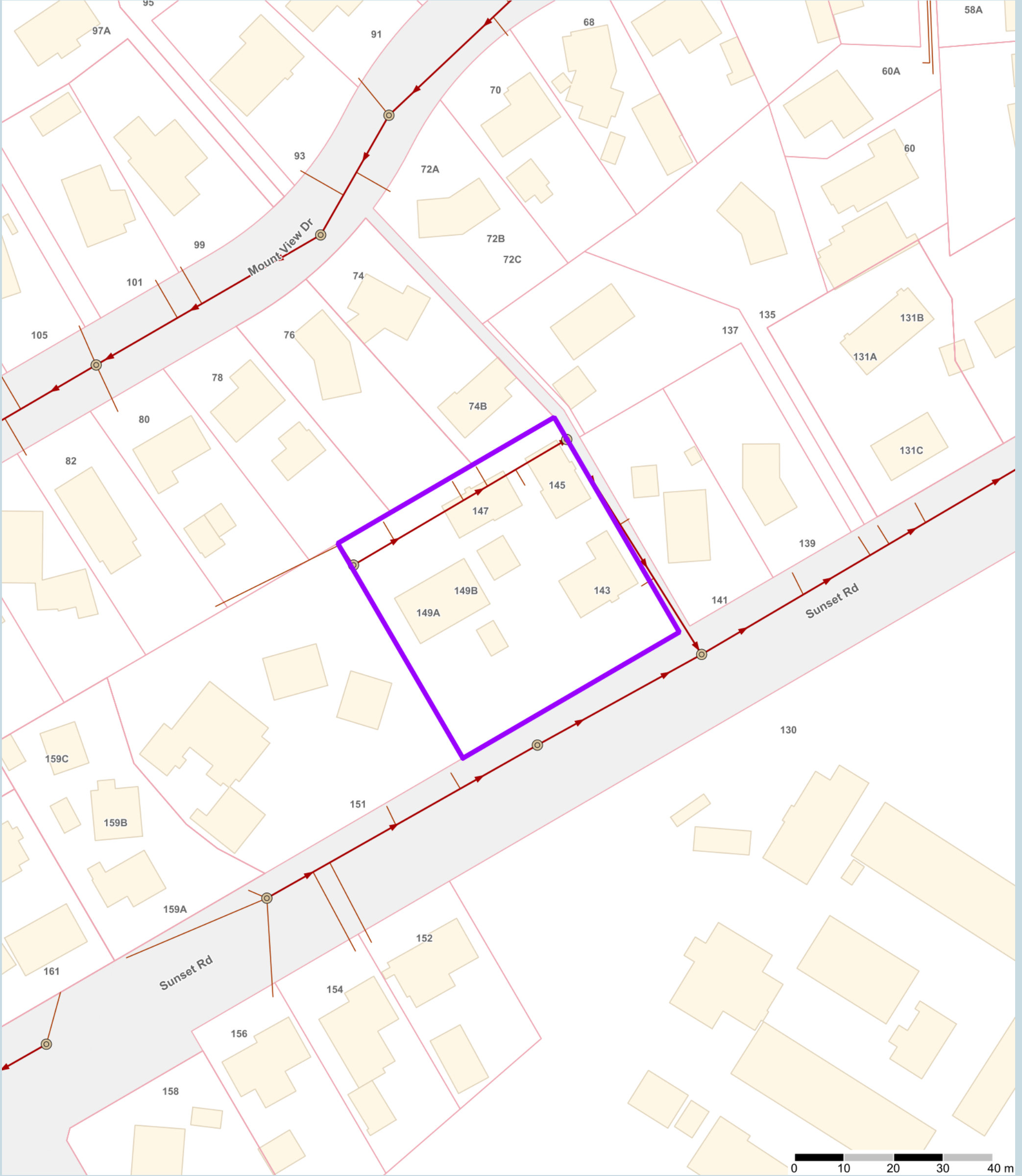

Manhole	End of Line - Cleaning eye	Wetwell Pump	Gate Valve	Gravity Main	Parcel
Inspection Point	Inline Cleaning Eye	Drywell Pump	Air Valve	Rising Main	Structure Roofline
Inspection Chamber	End of Line - Capped		Service Line	Contour (1m)	

DATA SETS: Accuracy of property boundaries +/- 0.2m – 0.3m in urban areas and up to +/- 50m in rural areas. Property boundaries, titles, legal descriptions and legal areas sourced from LINZ. Structure Rooflines sourced from 2016 and updated from 2024 imagery.
LINZ licenses. CROWN COPYRIGHT RESERVED. Council does not warrant the accuracy of the information represented by this map.

