



**RECORD OF TITLE
UNDER LAND TRANSFER ACT 2017
CROSS LEASE**

**Guaranteed Search Copy issued under Section 60 of the Land
Transfer Act 2017**



R.W. Muir
Registrar-General
of Land

Identifier SA33B/576
Land Registration District South Auckland
Date Issued 02 May 1985

Prior References
SA12D/434

Estate Fee Simple - 1/2 share
Area 809 square metres more or less
Legal Description Lot 4 Deposited Plan South Auckland 6546

Registered Owners
Thomas Hunter Vincent and Emily Ann Redman

| | | | |
|---------------|-----------|-------------------|---|
| Estate | Leasehold | Instrument | L H587079.1 |
| | | Term | 999 years as from and including 31.10.1984 |

Legal Description House 1 Deposited Plan South Auckland
36991 and Shed 1 Deposited Plan South
Auckland 36991

Registered Owners
Thomas Hunter Vincent and Emily Ann Redman

Interests

H587079.1 Lease of House 1 and Shed 1 DP South Auckland 36991 Term 999 years as from and including 31.10.1984
Composite CT SA33B/576 issued - 2.5.1985 at 11.58 am (Affects Fee Simple)

B090491.3 Variation of Lease H587079.1 produced 6.7.1992 at 2.45 pm and entered 30.7.1992 at 9:00 am

B090491.6 Lease of Flat 1 DPS 38885 Term 999 years commencing on 10.7.1985 Composite CT SA50D/891 issued
produced 6.7.1992 at 2.45 pm and entered 30.7.1992 at 9.00 am

Land Covenant in Lease B090491.6 produced 6.7.1992 at 2.45 pm and entered 30.7.1992 at 9.00 am

11982015.2 Mortgage to New Zealand Home Lending Limited - 24.12.2020 at 7:13 am

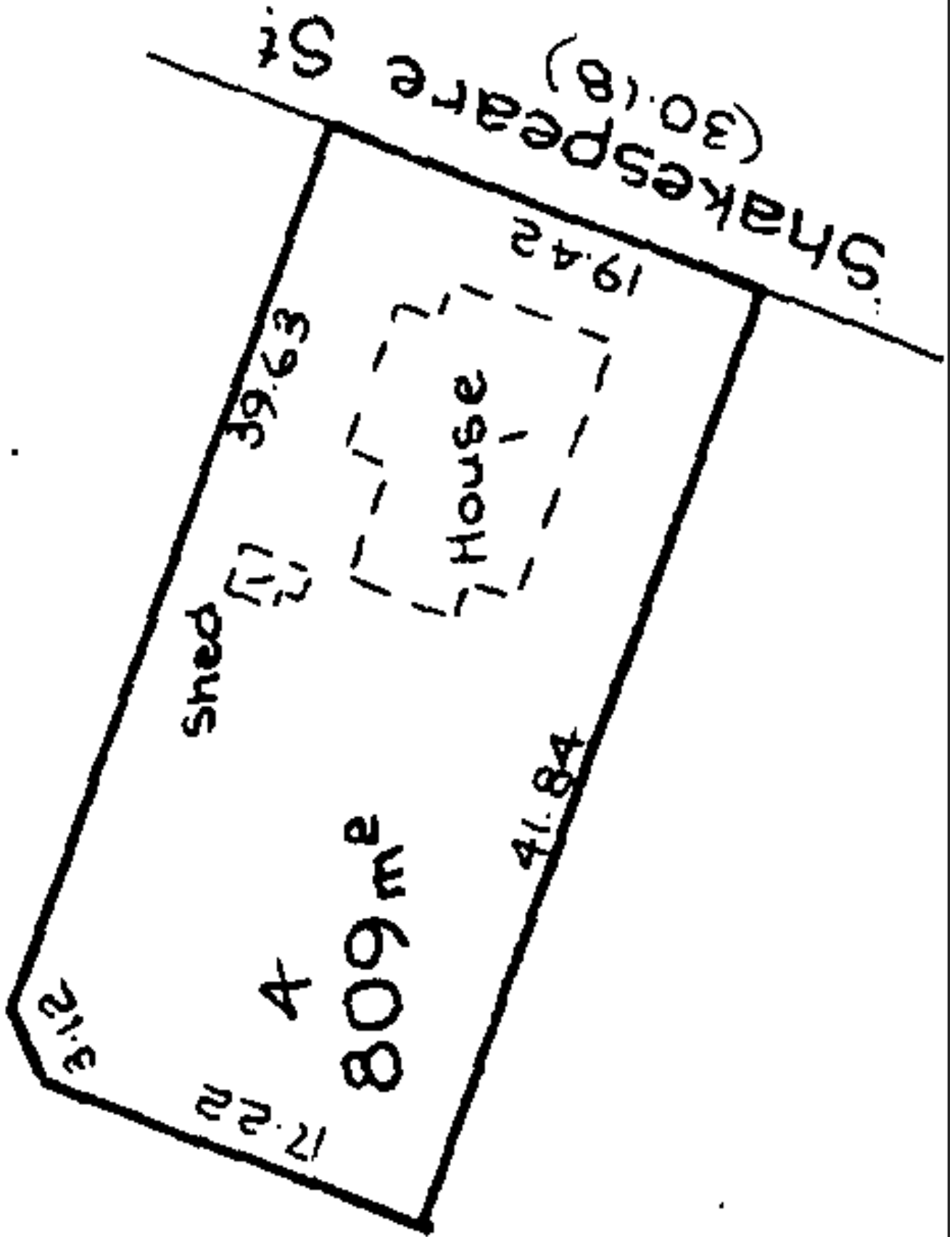

Statement of Passing Over

This information has been supplied by the vendor or the vendor's agents and Success Realty Limited (Bayleys) is merely passing over this information as supplied to us. We cannot guarantee its accuracy as we have not checked, audited, or reviewed the information and all intending purchasers are advised to conduct their own due diligence investigation into this information.

Where you have been supplied with a Council Property File please note there may be matters relating to pre-1992 consents or permits in this file which may need further investigation in order to determine their relevance.

To the maximum extent permitted by law we do not accept any responsibility to any party for the accuracy or use of the information herein.