

Refer to 'BARR + HARRIS LAND SURVEYORS' for final boundary information.

NOTE:
Boundary lines are indicative only.

Subdivision of Lot 11 DP 13191
 Lot: 2 (new)
 DP: TBA
 Site Area: 528m² exclusive
 Gross Plan Area: (161.2m² house) 192.7m² total
 (incl. covered entry and patio area)
 Territorial Authority: Matamata Piako DC
 Planning Zone: Residential (Infill housing)
 Site Coverage: 36.5% (45% max)

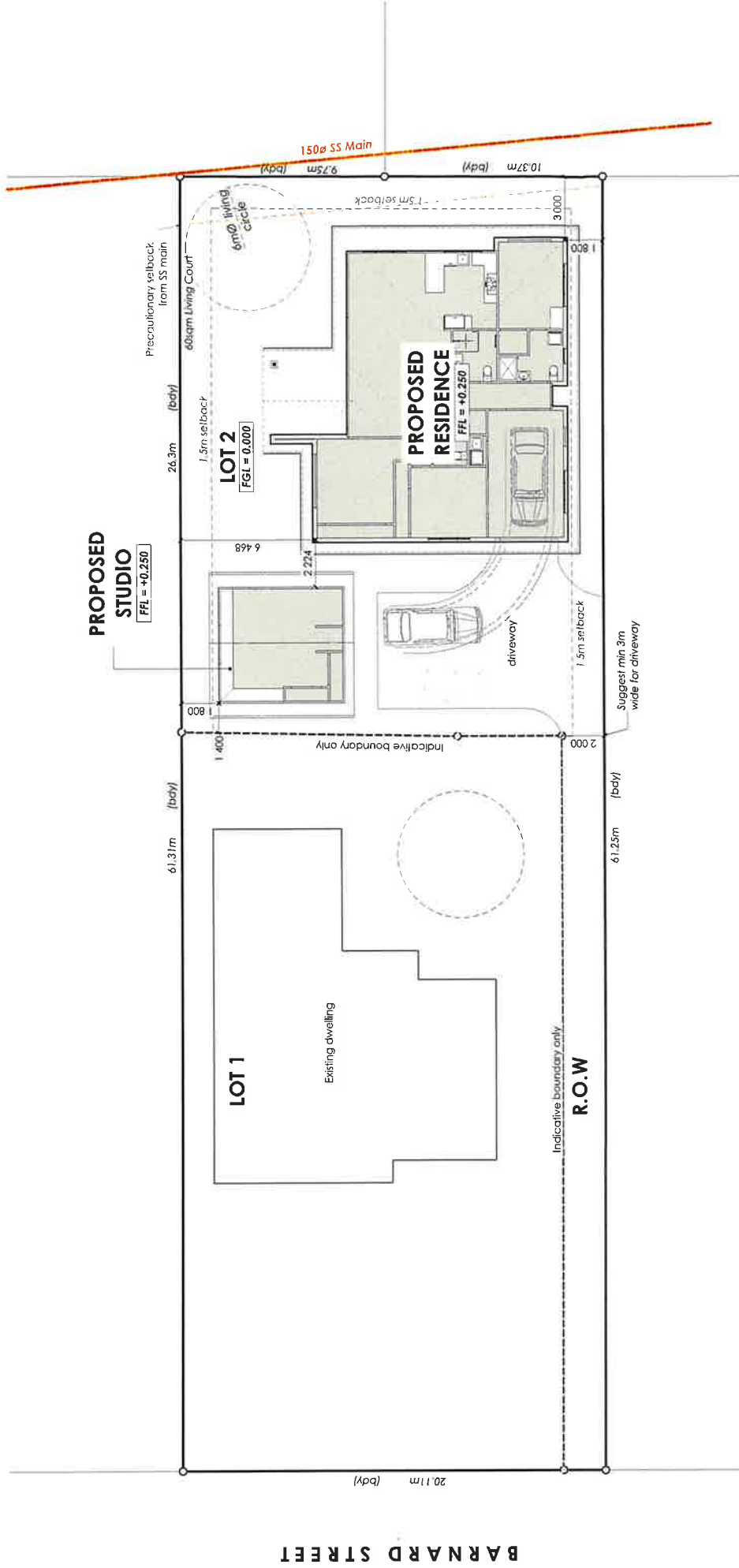

DO NOT scale off drawings. Cross reference all drawings, confirm site levels, floor heights & rations prior to earthworks. Any discrepancies MUST be clarified with the designer or contractor immediately before commencing works or ordering. All contractor/Authorized parties of the Owner/Builder shall ensure that all works comply with the requirements of the Territorial Authority, NZBC & NZS 3604:2011. Contractor to have a firm understanding of the NZBC & NZS 3604:2011. Any work undertaken outside these requirements without the prior written approval of the Designer, Engineer and/or Territorial Authority hereby indemnifies the designer against any claims in respect of the said work. NO construction or site works are to commence until building consent becomes unconditional. COPYRIGHT: Any and all drawings commissioned remain the property of Heartland Homes Limited, including all copyright and similar rights subsisting in these drawings, and are solely for use as described on the drawings, and may not be used for any other purpose or reproduced in whole or in part without written permission obtained from Heartland Homes Limited.

Client: **P. & J. Challis**
 Address: **7 Barnard Street Matamata**

 Call: 07 883 3014

Drawing title
SITE PLAN

Units:	5/07/2022
Drawn by:	Amy
Wind:	High
EQ:	1
Exposure:	B
Climate:	2
Scale:	1:200
Job No.:	14299
Sheet:	2 of 2